

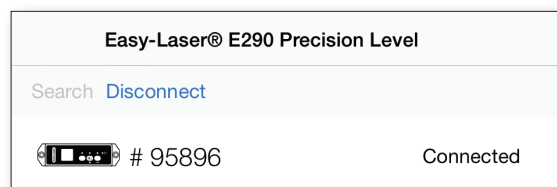

Precision level Quick guide

Connect

1. Download our Precision level app from the App Store.
2. Start your Precision level. See next page for hardware information.
3. Open the app and tap **"Search"** to search for Precision levels.
4. Tap the Precision level you want to connect to.



Measure

Tap to measure.

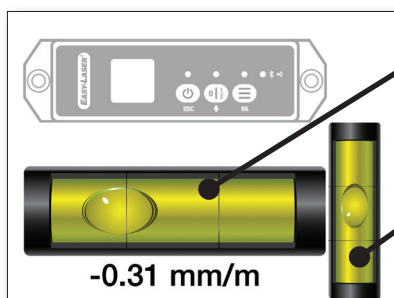

Outside the high accuracy measurement range (± 2 mm/m), the angle is presented in degree (as rough reference).

Use the small indicator only as a guide to ensure that the Precision level is placed correctly on top of the measurement object (for example a roll).

Register

Tap to start registering values.

- Tap to register values. Values are added to the list.
- Tap to add a note about the registered value.
- Tap to delete a value.
- Tap to start a new measurement. All registered values will be deleted

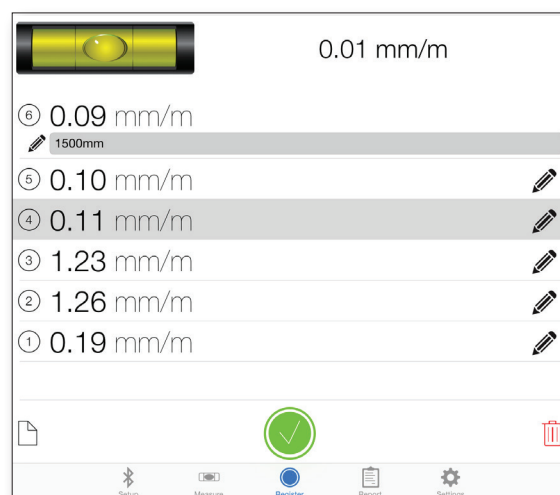

Report

Tap to view the report.

- Tap to share the measurement report via e-mail, Dropbox or save it in iBooks for example.
- Tap **"Enter report info"** to add measurement name, operator name and notes.
- Tap **"Add photo"** to add a photo to the report.

Settings

Tap to select unit.

Supported versions

Precision level firmware: 2.0 or later.

Precision Level E290

Part no. 12-0846

Note!

Machined surface. Keep clean and dry. Grease surface when not in use.

Note!

To reach full accuracy, make sure that the temperature of E290 has stabilized in the measurement environment.

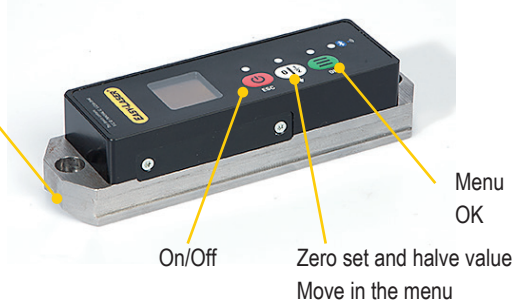

Change unit

Press and select "Unit". Choose from the following units: mm/m, inch/foot, degrees or arc sec. Use to move in the menu.

Calibration

The Precision level is calibrated on the factory. To calibrated on site:

1. Place the Precision level on a roll (or the object you are going to measure). Make a mark to ensure that you place the Precision level in the same position.
2. Press and select "Calibration".
3. Wait until the value has stabilized. Press .
4. Rotate the Precision level 180°. Wait until the value has stabilized.
5. Press . The Precision level has been calibrated. The calibration is saved even when the Precision level is switched off.

Factory recall

Press and select "Fac. recall" to return to factory settings.

Visible

By default the precision level is set to visible. This means it will be shown when searching for Bluetooth units. To save energy, the precision level is set to not visible once a Bluetooth connection is established.

Connect to Display unit

Connect the Precision level to the Display unit via Bluetooth®.

Use the small indicator **only as a guide** to ensure that the Precision level is placed correctly on top of the measurement object.

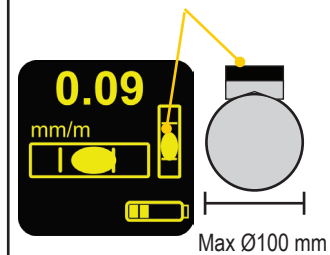

When measuring a shaft using the Precision level, we recommend that the shaft is no larger than 100 mm in diameter.

Safety strap

Use the safety strap to prevent equipment from falling and causing injuries.



Precision level E290	
Resolution	0.01 mm/m (0.0001°)
Range	± 2 mm/m
Measurement error	Range ±1mm/m: accuracy within ±0.02mm/m of displayed value. Range ±2mm/m: accuracy within ±0.04mm/m of displayed value.
Type of display	OLED
Wireless communication	Class I Bluetooth® wireless technology
Environmental protection	IP Class 67
Operating temperature	-10–50 °C
Internal battery	Li Po
Material	Hardened, polished and corrosion resistance steel, ABS plastics
Dimensions	WxHxD: 149x40x35 mm [5.9x1.6x1.4"]
Weight	530 g [18.7oz]