



Release Notes

Installation instructions

Go to www.easylaser.com>Support>Software download

1. For XT12 Display unit: Download XT12 app update file.
For XT11 Display unit: XT11 display unit firmware update.
NOTE! This is a very large file! (approximately 1.3 GB)
2. Download the update file and save it to a USB memory stick.
3. Unzip the files to the root of the USB memory stick.
4. Start the Display unit.
5. Insert the USB memory stick into the Display unit.
6. On the start view, tap  to open Settings.
7. Tap  to open System information. The installation file should now be visible under UPDATE.
Tap the installation file. If the Display unit doesn't restart within five minutes, start it manually.

Detector update

The software update file also contains updates for detectors.

To check if your detector has an update available:

1. Connect your Display unit and detector to power.
2. Open “Settings” and “System Information”.
3. Tap “Detector update” and select a detector from the list.
The Update-button is active if the selected detector has an available update.
4. Tap “Update”. The update can take up to 15 minutes.

Installation instructions and Detector update instructions in **German, Spanish and Swedish** are found on the last pages of the Release notes.

Release 10.2.0

Data collection:

When tapping “OK”, you allow Easy-Laser to collect anonymous usage and diagnostics data, for example what measurement programs are being used. This helps us make this app better. No personal data, for example actual measurement data, results or reports, will be collected. You can change your choice at any time in Settings > System information.

- Data collection added.
- A pop-up to inform the user regarding this. It is possible to change the decision later in Settings > System information.

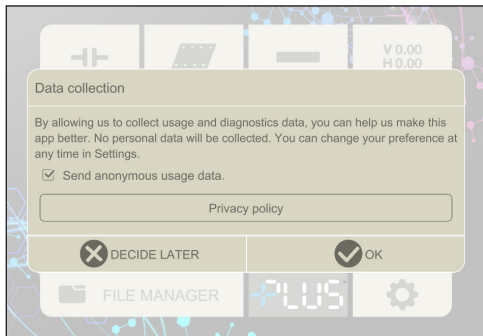

Data collection information pop-up.

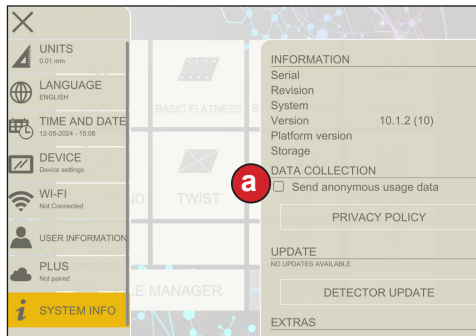

Settings > System information: Tick box [a] to allow data collection. You can disallow at any time by unticking the box.

Straightness Bore center:

- Unit information added in Prepare view.
- Possible to halve and zero set value when having the live device zoomed in Connect view.
- Updated distance icon on Prepare, Measure and Result views, makes it clear that distance is measured from the first bore/position.
- More clear which bore has been measured, checkmarks added.

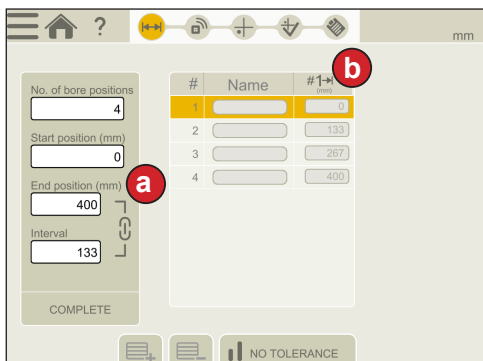

Unit information added in Prepare view [a] and updated distance icon [b].

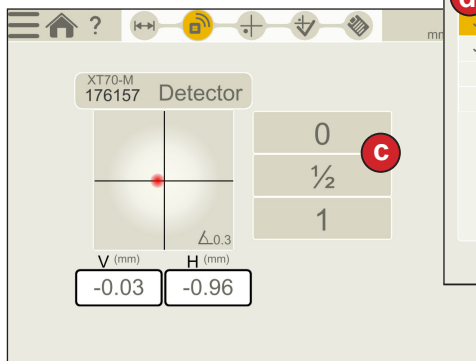

Halve and zero set value [c] when live device is zoomed in Connect view.

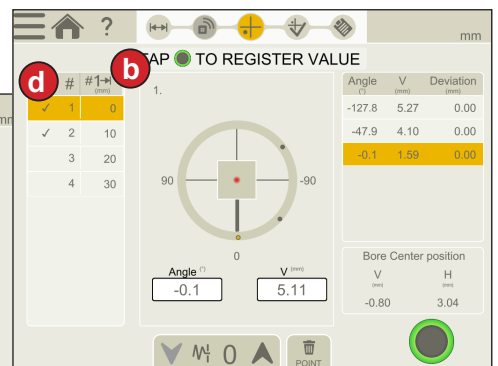

Updated distance icon [b] and checkmarks added on measured bore [d].

Languages:

- Two new languages added in the app, Thai and Vietnamese. **Not** available in the manual yet.

Release 10.1.2

Improvements:

- In Machine train, it is now possible to adjust any of the measured couplings. The user is asked to ensure that the distances are correct.
- A PLUS button added to the start view. When pressed, more information regarding Easy-Laser PLUS is shown.
- Improved scaling in the live adjust view for Shaft Horizontal.
- It is now possible to remove old mail addresses from the list “Previously Used” on XT11/XT12.

Bug fixes:

- The Share functionality on Android is working again.
- The report now updates to the latest Manual entry value.
- The connection problem with some Android and firmware 6.0.0 has been solved.
- In the report, the “Time since calibrated” for XT22 would display wrong value if not calibrated by customer. Now it shows: N/A if not calibrated by customer.
- Traditional Chinese corrected in Start menu.
- In Basic Flatness and Twist: both X and Y values are now zeroed in the target.

Release 10.1.1

Machine Train:

- Manual entry.
This option is used to combine the current Machine Train measuring method with the possibility to manually add external measurement values for certain couplings.

Straightness Bore center:

- Distance for end position active after start position has been entered.
- Added a warning regarding the need for minimum angle between the points.
- Updated icon.
- Bug fixed: When clearing the number of position showed a strange number.

Straightness:

- Bug fixed: Old straightness files can now be opened from file manager.

Shaft Horizontal:

- The view for V&H is now default.
- Bug fixed: The distance for S machine was activated when scrolling the images.

Other fixes:

- Less memory used when updating the system.
- More stable live graph view in Machine Train.
- Improved filter handling.
- Repositioned a button in Twist. The delete last measurement button was clipped.
- Translation fixes.

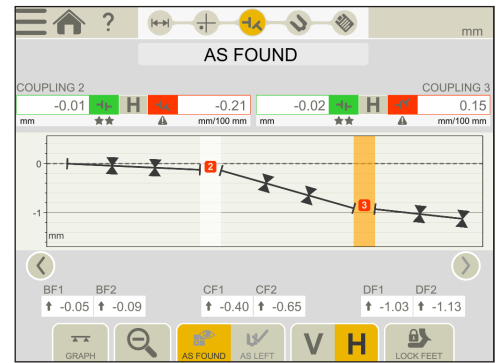

In the Result view, you can select the coupling you want to adjust.



In Measure view, select Manual entry.

Release 10.0.1

Straightness Bore Center

New program added!

Measure the straightness of bore center lines, bearing journals and other cylindrical objects. It is possible to measure up to 50 points on each bore/bearing position. The measured points are clearly displayed in a graph and table.

The XT9 or XT70 can be used as detectors.

Straightness:

A Prepare view has been added to the Straightness program.

Much like the one used in Straightness Bore Center.

Detector XT9:

It is now possible to connect the detector XT9.

Available in Straightness, Straightness Bore Center and Values.

Other improvements:

- Built-in Turkish manual now available.
- More responsive Start screen.

Bugs fixed:

- Fixed the lagging values on XT11 and XT12. Seen on the Adjust screen.
- Fixed an issue with taking photos.
It is now possible to take multiple photos within the same minute.
- Minor translation fixes.

Release 9.2.0

Shaft:

- Adjust view in Horizontal, the tab for live adjustment modes are now expanded by default.
- Lock feet also available in Machine view.

Fixed bugs:

- On certain Android tablets, there were major graphic issues. Icons were not visible.
- The QR scanner could crash when opened from the Start view.
- There were problems displaying values in the Vibration program for certain languages.
- Reimplemented locked feet icons in Machine train.
- Locked feet were not set by default on all S-machines when switching image in Configuration.

Release 9.1.0

Turkish added in the app.

Issues fixed in this release:

- Improved app performance (mostly seen in XT11 and XT12).
- Stability fixes to PLUS functionality.
- Stability fixes to XT12 update functionality.

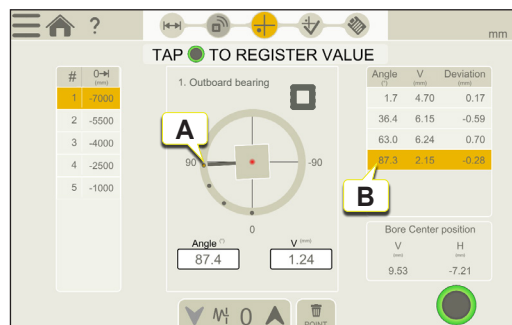

Measured points [A]. Registered measurement values [B].

Release 9.0.0

Easy-Laser PLUS™:

This is our cloud solution where you can:

- Collect all your measurement files in one place for quick overview and analysis.
- Restore deleted files.

In Settings, just pair your XT app to Easy-Laser PLUS™ and all files in your File manager are automatically uploaded to Easy-Laser PLUS™.

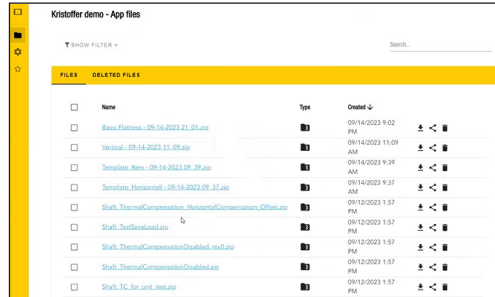
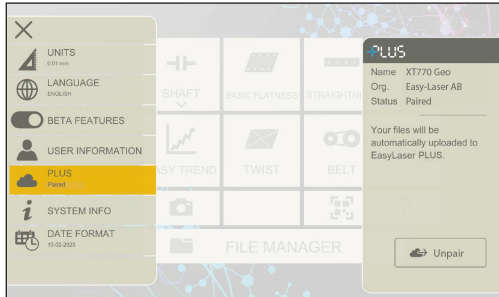

In Settings, just pair your XT app to Easy-Laser PLUS™... .. and all your files are uploaded to Easy-Laser PLUS™.

For information on how to pair your XT app to Easy-Laser PLUS™, follow the instructions in the XT app User Manual: GENERAL INFORMATION > Easy-Laser PLUS.

For more extensive information regarding all Easy-Laser PLUS™ features, see www.easylaser.com

Bugfixes:

- In XT12, the screen could stop working when setting time and date in Settings.
- When you mirrored machines in Horizontal, they were misplaced in V/H view.
- Sweep readings were not visible.
- Location permission is no longer required for Android 12 and above.

Release 8.4.2

Shaft horizontal:

- Both machines are visible in V/H view.
- Possible to toggle between V, H and V/H.

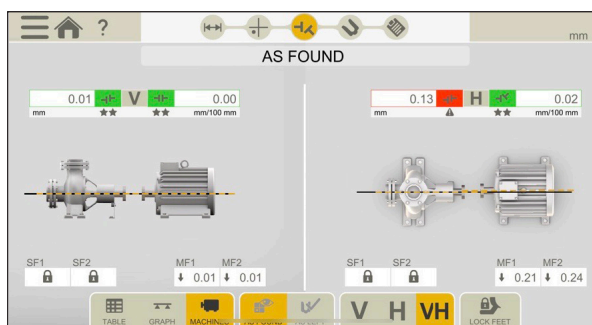

Both machines are visible in V/H view.

Fixed problems with:

- Reversed Softtfoot results for the S machine in the report.
- Lock feet did not work in a mirrored view.
- Icons in Adjustment view was not visible.
- Manual not available on certain Android devices.

Release 8.4.0

- Fixed a bug where XT11 would freeze after a while.
- It is now possible to change the logo in the report again.
- Minor translation fixes.

Shaft

- Graphs in Adjust view. It is now possible to select Graph view when adjusting.
- Changed layout of the graphs in Result view.
- Lock feet: Same procedure in both Horizontal and Machine train. Possible to lock only one pair of feet.
- Updated train report, now showing tolerance indicators and warnings.

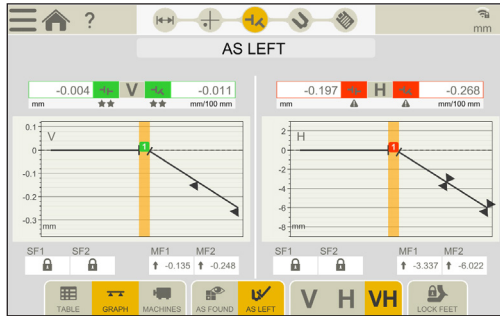

New graph layout in Result view.

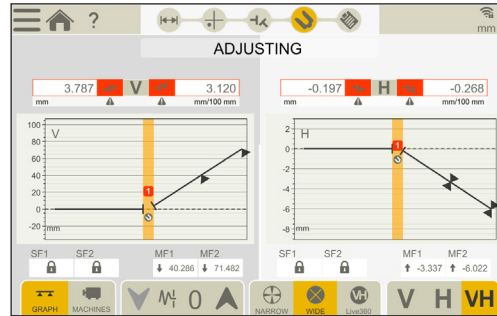

Possible to select Graph view when adjusting.

Filter

- Enhanced filters

Release 8.3.4

- Fixed a problem with programs not starting on Android.
- Fixed a problem with the camera function on Android.
- Updated the default report names for Horizontal, Cardan and Belt.

XT11 and XT12

- Fixed a problem in the time settings, when changing the time manually.
- Fixed a problem with time shown in reports.

Release 8.3.3

All programs

- Added support for sending emails to multiple recipients by separating with space, comma or semicolon.
- Added support for turning off keyboard sounds and vibrations for XT12.
- Improved file naming when working with templates. The name of the template will be suggested when Finalizing the measurement.
- Photos are not added (and saved over) automatically to reports anymore and must instead be added manually in the report.
- Added shortcut to Wi-Fi settings from the Start screen.

Shaft

- Improved machine train report. The first page of the report now shows more information.
- Added RPM input field to Cardan Prepare view.
- Changed icons for vertical foot adjustment in Shaft programs. Previous icon was not clear and has been changed to arrows.
- Increased threshold for Sweep direction error slightly.

- Fixed a bug with the default name when adding a custom tolerance.
- Fixed a bug with detector serials in reports. In some cases they would say “Demo” even though real ones were used.

Other

- XT12 screen no longer rotates.
- Added possibility to toggle 24h/12h time format in Vibration report.
- Added unit information to Values autorecord settings.
- Fixed a bug and re-added Twist to XT550.
- Fixed a bug with time format.
- Various minor visual bug fixes.

Release 8.1.1

- New background image.
- Changed the default tolerance in Cardan.
- Fixed a connection problem in Horizontal.
- In EasyTrend, fixed a problem with the start and stop line.
- Several minor translation fixes.
- Several minor visual bug fixes.

Display unit XT11

NOTE! As of November 2022, the XT alignment app will no longer support the XT11 rev 1 Display unit (serial number 129231 or lower). XT alignment app version 8.1 and higher will not be compatible with XT11 rev 1.

Release 8.0.17

- Fixed communication bugs on Android.
- Various other bug fixes.

Release 8.0.15

Shaft

- Simulations made in the Adjustment Guide will no longer affect the adjustment view. Your simulated adjustment values will **NOT** be saved and used in the Adjustment view.
- The latest measurement method used is now permanent until another method is selected (for example 9-12-3 or EasyTurn).
 - The selected measurement method is saved after doing a Softfoot measurement.
 - The latest measurement method used, will be reselected for new measurements.
- The result view (table, graph or machine) is now permanent until another view is selected.
 - The latest result view used, will be reselected for new measurements.
- Fixed a bug and re-added XT50 to Cardan.
- It is no longer possible to select other measuring units while in the middle of a Sweep measurement for example.

EasyTrend



- Added start and end **date** to the EasyTrend report.
- Not possible to finalize the measurement while measuring. You need to stop the measurement before finalizing it.

Values

- Added the button “Delete All” to delete all registered values.
- Fixed the icon for angle settings in Values.

Installationsanweisungen

Gehen Sie zu www.easylaser.com > Support > Software Download.

1. Für XT12 Anzeigeeinheit: Laden Sie die XT12-App-Update-Datei herunter.
Für XT11 Anzeigeeinheit: **Hinweis** zum Firmware-Update für die XT11-Anzeigeeinheit:
Dies ist eine sehr große Datei! (ca. 1,3 GB).
2. Laden Sie die Update-Datei herunter und speichern Sie sie auf einem USB-Speicherstick.
3. Entpacken Sie die Dateien in das Stammverzeichnis des USB-Speicherstick.
4. Starten Sie die Anzeigeeinheit.
5. Stecken Sie den USB-Speicherstick in die Anzeigeeinheit.
6. Tippen Sie in der Startansicht auf , um die Einstellungen zu öffnen.
7. Tippen Sie dann auf , um die Systeminformationen zu öffnen. Eine neue Datei sollte jetzt unter UPDATE sichtbar sein.
Wenn die Anzeigeeinheit nicht innerhalb von fünf Minuten neu gestartet wird, muss sie manuell gestartet werden.

Detektor-Update



Die Software-Update-Datei enthält auch Updates für Detektoren.

So überprüfen Sie, ob für Ihren Detektor ein Update verfügbar ist:

1. Schließen Sie Ihre Anzeigeeinheit und Ihren Detektor an die Stromversorgung an.
2. Öffnen Sie „Einstellungen“ und „Systeminformationen“.
3. Tippen Sie auf „Detektor-Update“ und wählen Sie einen Detektor aus der Liste aus.
Der Update-Button ist aktiv, wenn für den ausgewählten Detektor ein Update verfügbar ist.
4. Tippen Sie auf „Update“. Das Update kann bis zu 15 Minuten dauern.

Instrucciones de instalación

Vaya a www.easylaser.com > Soporte > Actualizaciones de software.

1. Para la unidad de visualización XT12: Descargue el archivo de actualización de la app XT12.
Para la unidad de visualización XT11: Actualización del firmware de la unidad de visualización XT11.
Nota: Es un archivo muy grande (aproximadamente 1,3 GB).
2. Descargue el archivo de actualización y guárdelo en una memoria USB.
3. Descomprima los archivos en la carpeta raíz de la memoria USB.
4. Encienda la unidad de visualización.
5. Inserte la memoria USB en la unidad de visualización.
6. En la vista Inicio, toque  para abrir la pantalla de Configuración.
7. Toque  para abrir la Información del sistema. El archivo de instalación deberá ser visible ahora en ACTUALIZAR.
Si la Unidad de visualización no se reinicia en cinco minutos, iníciela manualmente.

Actualización del detector



El archivo de actualización de software también contiene actualizaciones para los detectores.

Para comprobar si hay una actualización disponible para su detector:

1. Conecte la unidad de visualización y el detector a la alimentación.
2. Vaya a «Configuración» e «Información del sistema».
3. Toque «Actualización del detector» y seleccione un detector de la lista.
El botón Actualizar estará activo si hay una actualización disponible para el detector seleccionado.
4. Toque «Actualizar». La actualización puede durar hasta 15 minutos.

Installationsinstruktion

Gå till www.easylaser.com > Support > Programvaror.

1. För Avläsningsenhet XT12: Ladda ner XT12.
För Avläsningsenhet XT11: XT11 Firmware-uppdatering.
Obs! Detta är en mycket stor fil. (ca 1.3 GB)
2. Ladda ner uppdateringsfilen och spara den på ett USB-minne.
3. Packa upp filerna till roten på USB-minnet.
4. Starta Avläsningsenheten.
5. Sätt i USB-minnet i Avläsningsenheten.
6. På startvyn, tryck  för att öppna Inställningar.
7. Tryck på  för att öppna Systeminformation. En ny fil bör nu vara synlig under UPPDATERINGAR.
Om Avläsningsenheten inte startar om inom fem minuter, starta den manuellt.

Uppdatera detektor

Mjukvaru-uppdateringsfilen innehåller även uppdateringar för detektorer.

För att kolla om det finns tillgängliga uppdateringar för din detektor:

1. Sätt på din avläsningsenhet och detektor.
2. Öppna “Inställningar” och “System Information”.
3. Tryck på “Uppdatera mätenheter” och välj en detektor från listan.
Uppdatera-knappen är aktiv om det finns en tillgänglig uppdatering för den valda detektorn.
4. Tryck på “Uppdatera”. Uppdateringen kan ta upp till 15 minuter.